

General Description

The CENTRAN TMB features a single-stage centrifugal impeller and a magnetic drive. The range of TMB pumps includes five models to deliver flows from 4 - 18.5 gpm and heads from 7.8 - 35 feet.

The CENTRAN TMB is made entirely of thermoplastics, with outstanding chemical and mechanical resistance made from glassfiber reinforced polypropylene (GFR/PP). Materials of construction on wetted end components are ceramics for the spindle, reinforced PTFE bearings, and a FKM O-ring gasket.

The drive magnet, located outside the casing and attached to the motor shaft, drives the magnetic impeller inside the casing. The traditional shaft seal and the consequent leakage problems are eliminated. There is no corrosion of the outer parts (motor and bearings) in the environment.

The CENTRAN TMB's compact size, low noise, and absence of a mechanical seal make these pumps ideal for many applications.

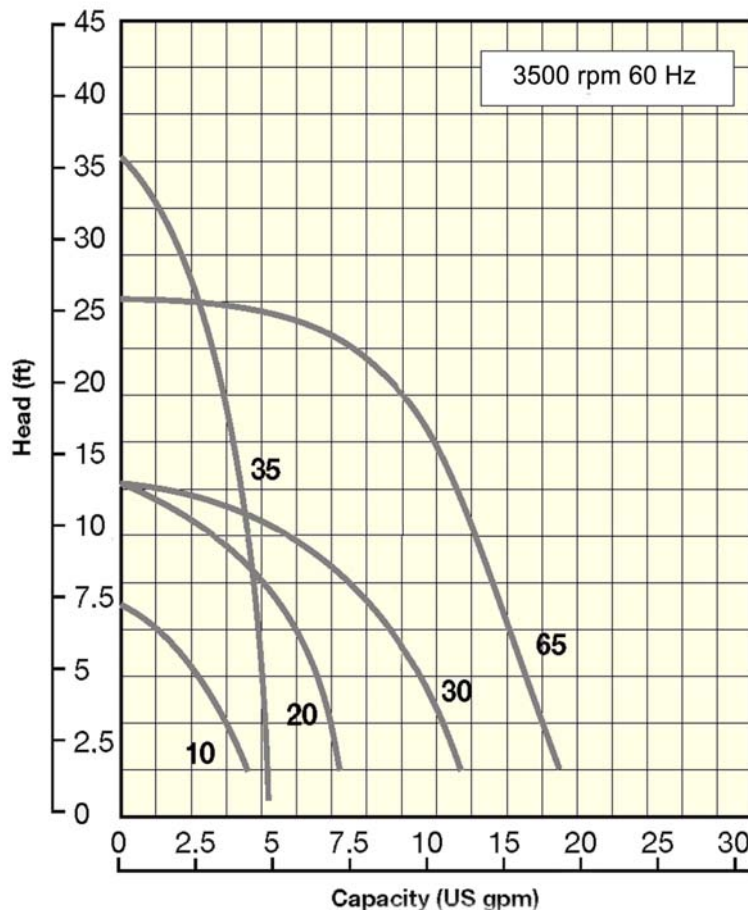

Materials of Construction

The drive magnet assembly is constructed of ferrite magnets. The volute casing is a monolithic injection moulded part, made of glass reinforced polypropylene with an encapsulated GFR/PTFE front spindle bearing. The connections can be either NPT or hose barb. The rear casing is made of the same thermoplastic material as the front casing and contains the rear spindle's bearing. The polypropylene impeller features a built-in ceramic spindle and ferrite magnets.

Constructive Dimensions

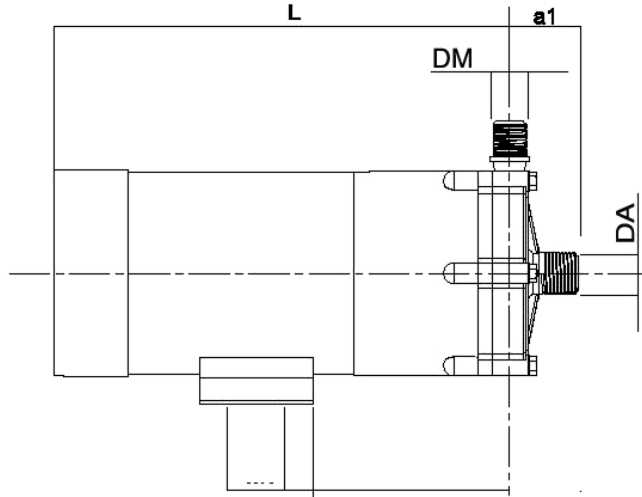
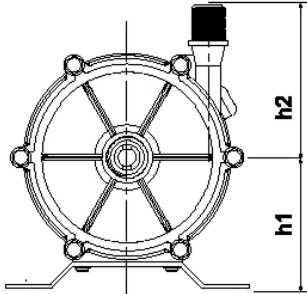

Temperatures

| Version | 10-20-30-35-65 |
|---------------------------|------------------------|
| Reinforced Polymers | GFR/PP |
| Ambient Temperature | 113°F |
| Liquid Temperature | 140°F |
| Environmental Temperature | 32°/113°F (0°/45°C) |

Applications

- Water treatment
- Aquariums
- Graphic art machinery
- Dyeing and etching equipment
- Medical equipment
- Photographic developing process
- Chemical laboratories
- Storage batteries manufacturer
- Electroplating and silver recovery
- Metalwork machinery
- Fungicide and pesticide
- Refrigerators
- Ice making machines
- Beverage vending machines
- Corrosive chemical solutions
- Sea water
- Pure water (demineralized water)
- Chemicals to preserve food
- Descaling
- Solar systems
- Laser systems
- Toxic liquids
- Laundry
- Cosmetic industry

Pump Dimensions

| TMB | 10 | 20 | 30 | 35 | 65 |
|-------|------|------|------|------|------|
| a_1 | 1.25 | 1.5 | 2 | 1.5 | 2.5 |
| h_1 | 2 | 2.25 | 2.5 | 2.5 | 2.75 |
| h_2 | 2 | 3 | 3 | 3 | 3.5 |
| L | 4 | 7.25 | 8.25 | 8.25 | 8.75 |
| DM | * | 3/4" | 3/4" | 3/8" | 1" |
| DA | * | 3/4" | 3/4" | 1/2" | 1" |

Note: Dimensions are rounded to the next quarter inch.
*Hose barbed connections only 0.55 inches.

Materials

| TMB | 10 | 20 - 30 - 35 - 65 |
|----------------------|-----------------|-------------------|
| Execution | WR | WR |
| Internal structure | N1 | N1 |
| Volute casing | GFR-PP | GFR-PP |
| Rear casing | | |
| Centrifugal impeller | - | GFR/PTFE |
| Guide bushing | | |
| Spindle | CER | CER |
| Thrust bush | GFR/PTFE | GFR/PTFE |
| O-ring gasket | FKM | FKM |
| Screws | Stainless Steel | Stainless Steel |