

In-Line Centrifugal Pumps

Series 320 Advantages

Weinman in-line centrifugal pumps are designed specifically for heating, air conditioning and industrial applications. Suction and discharge nozzles are located 180° apart on the same centerline for mounting directly in a pipe line. This eliminates critical pipe alignment for ease of assembly and minimum pipe strain. The need for costly foundations is eliminated, which guarantees minimum space requirements. The motor and bracket assembly can be removed from the casing without disturbing the piping. The impeller, mechanical seal, bronze shaft sleeve, and bronze wear rings are therefore accessible for easy maintenance. Mechanical seals and bronze wear ring(s) are supplied as standard on certain pumps. A built in purge system assures proper flushing and venting of seals (see illustration). Standard NEMA frame motors with JM shafts in most models specifically designed for mechanical seal applications are used. Controlled tolerances and adequate bearings assure long life.



Features & Benefits

- Automatic purge system allows liquid to flow from high pressure side of impeller across seal face to low pressure eye of impeller, assuring proper lubrication and venting. Model 6012CV utilizes external venting.
- Manual vent plug ensures positive lubrication at start up.
- NEMA JM Frame motors are standard on all models.
- Front wear rings on all models. Rear wear rings on certain models.
- ANSI flanges standard 125lb (250lb available).
- Mechanical seal.
- Pressure gauge tappings at suction and discharge flanges.
- Motor can be rotated at 90° intervals for convenient junction box location.
- Drain Plug.
- Bronze motor shaft sleeve.
- Bronze enclosed impeller.

Heads to 360'
Flows to 1400GPM
Up to 60 HP

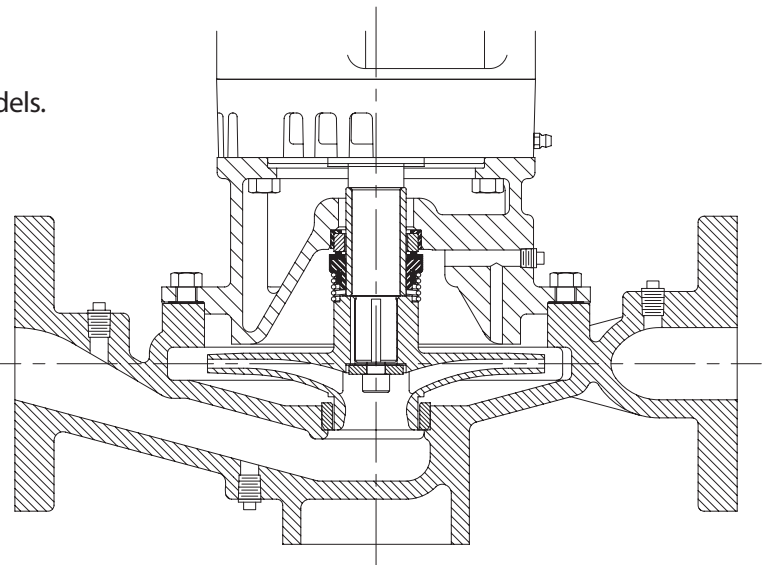

WEINMAN®

Series 320

MOTOR DIMENSIONS													
Motor Frames	143JM	145JM	145JM	182JM	184JM	213JM	215JM	254JM	256JM	284JM	286JM	324JM	326JM
1750rpm (HP)	1	1.5	2	3	5	7.5	10	15	20	25	30	40	50
3500rpm (HP)	1.5	2	3	5	7.5	10	15	20	25	30	40	50	60
C - ODP	10.5	11.5	11.5	12.5	13.5	15	16.5	18.75	20.75	21.5	23	24.5	25.5
O - ODP	7	7	7	9	9	10.62	10.62	12.5	12.5	14	14	16	16
C - TEFC	12	13	13	14.25	15.25	17.25	18.25	21.25	23	24.5	25.5	26	27
O - TEFC	7.25	7.25	7.25	9.37	9.37	11.12	11.12	13.25	13.25	15	15	17	17

PUMP DIMENSIONS (inches)										
Pump	Discharge	Inlet	X	YY	D	F Max	G Max	H1	H2*	
1507CV	1.5	1.5	7.5	7.5	3.75	5.13	4.75	4.25	-	
2007CV	2	2	7.5	7.5	4.37	5.50	4.94	4.43	-	
2507CV	2.5	2.5	8	8	5.25	5.75	5.13	4.53	4.97	
3007CV	3	3	9.5	9.5	5.75	6.43	5.43	4.43	4.97	
4007CV	4	4	10	10	6.12	7.5	6	4.78	5.25	
2095CV	2	2	9.5	9.5	4.5	6.75	6.31	3.88	5.03	
2595CV	2.5	2.5	10	10	5.5	7.38	6.63	3.97	5.19	
3095CV	3	3	11	11	6	8.06	6.81	3.88	5.03	
4095CV	4	4	12	12	6.81	9.25	7.43	3.97	5.19	
6012CV	6	6	15	14.5	7.5	9.81	8.31	5.37	5.37	

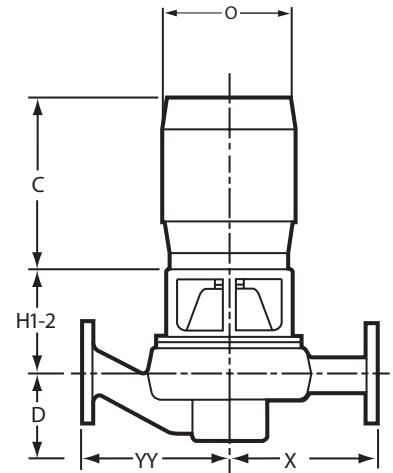
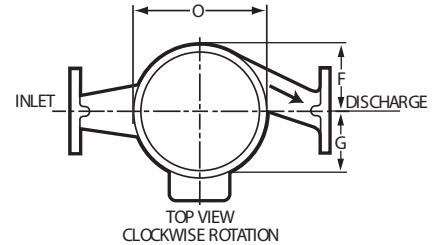

All dimensions are approximate and for illustration purposes only. For exact dimensions request certified dimensional prints. Motor dimensions "C" and "O" vary per manufacturer. 250lb ANSI flanges also available.

*Use with Motor Frame 254 JM and up

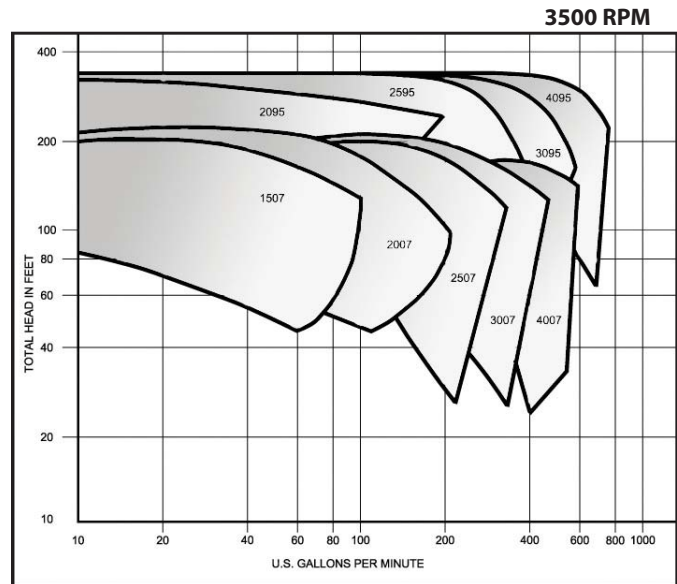
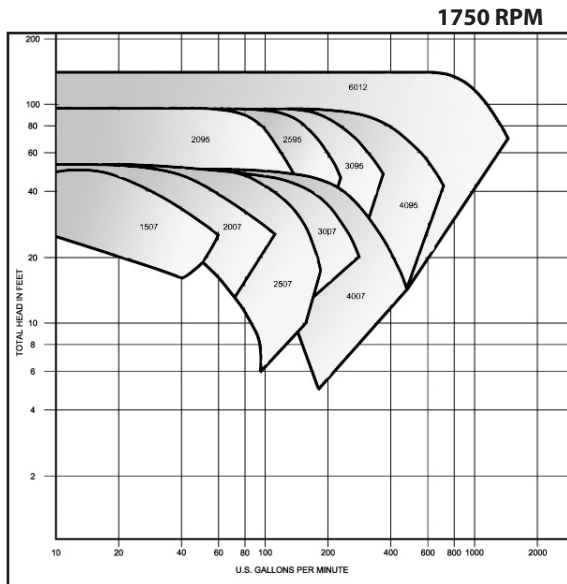

CRANE

PUMPS & SYSTEMS

A Crane Co. Company

Crane Pumps & Systems

420 Third Street
Piqua, Ohio 45356
(937) 778-8947
Fax (937) 773-7157
www.cranepumps.com

Crane Pumps & Systems Canada

83 West Drive
Brampton, Ont. Canada L6T 2J6
(905) 457-6223
Fax (905) 457-2650

Member of
Hydraulic
PUMP & SYSTEMS

Form W320BRO - 8/10
Crane Pumps & Systems®
Printed in U.S.A.