

ITT

Wastewater

Goulds Pumps

SP02/SP03

Submersible Sump Pump



FEATURES

- Corrosion-resistant construction.
- Stainless Steel motor casing and fasteners.
- Glass-filled thermoplastic impeller and casing.
- Bearings: Upper and lower heavy duty ball bearing construction.
- Motor is permanently lubricated for extended service life and is powered for continuous operation. All ratings are within the working limits of the motor.
- Stainless steel shaft.
- Complete unit is light weight, portable and compact.



Goulds Pumps is a brand of ITT Residential and Commercial Water.

www.goulds.com

Engineered for life

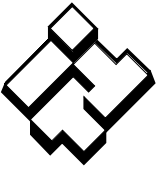

ITT

GOULDS PUMPS Wastewater

APPLICATIONS

Specially designed for the following uses:

- Basement draining
- Water transfer
- Dewatering

SPECIFICATIONS

Pump:

- Discharge size:
 - SP024 – 1 1/4" NPT,
 - SP025 – 1 1/2" NPT,
 - SP035 – 1 1/2" NPT.
- Capacities: to 40 GPM
- Maximum head: to 30 feet.
- Temperature: 104°F (40°C) maximum, continuous when completely submerged.
- Solids handling: 3/8" maximum spherical.
- Float switch: built-in non-mercury Vertical or Piggyback Wide Angle.
- Manual model also available – SP035M.
- Pumping range: 3.0".
- Maximum pump down - 1 1/4" from base.

MOTOR

- SP02: 1/4 HP, 115 V, 60 Hz, single phase 3400 RPM, 2.4 amps maximum.
- SP03: 1/3 HP, 115 V, 60 Hz, single phase, 3400 RPM, 3.0 amps maximum.
- Built-in thermal overload protection with automatic reset.
- Permanent-split-capacitor type.
- Class B insulation.
- Air filled design.
- Stainless steel shaft.
- Power cord: 10 foot standard length, heavy duty 16/3 SJTW with NEMA 5-15 P three prong grounding plug, 115V.

AGENCY LISTINGS



Tested to
CSA 22.2 108 Standards
By Canadian Standards
Association
File #LR38549



Underwriter's
Laboratories

Goolds Pumps is ISO 9001 Registered.

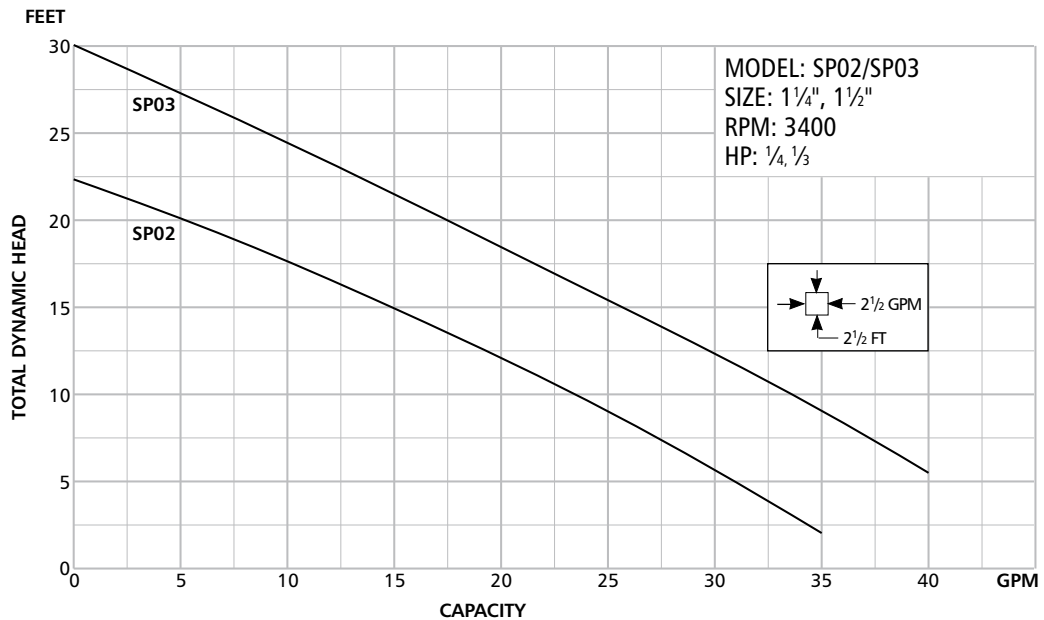

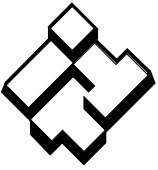

ITT

GOULDS PUMPS Wastewater

DIMENSIONS

(All dimensions are in inches. Do not use for construction purposes.)

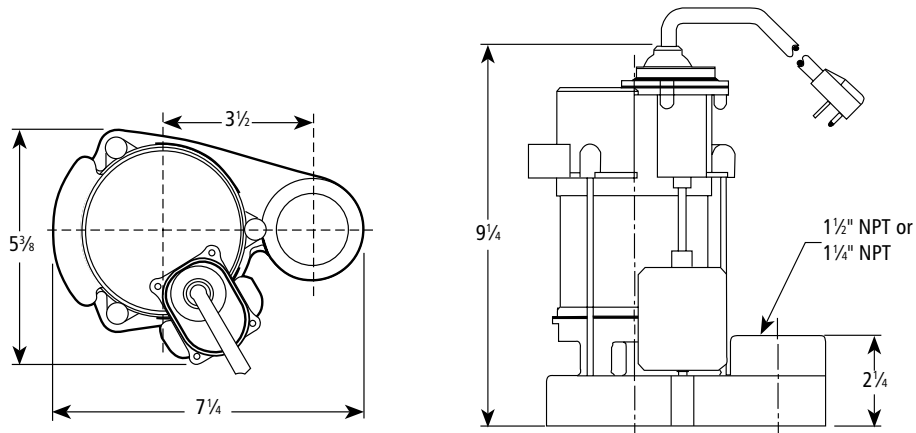

PERFORMANCE RATINGS

SP02

Total Head (feet of water)	GPM	GPH
5	31	1,860
10	23	1,380
15	15	900
20	5	300

SP03

Total Head (feet of water)	GPM	GPH
5	41	2,490
10	34	2,040
15	26	1,560
20	17	1,020
25	8	480

MODEL INFORMATION

Order No.	HP	Volts	Amps	Minimum Circuit Breaker	Phase	Float Switch Style	Cord Length	Discharge Connection	Min. On Level	Min. Off Level	Minimum Basin Diameter	Maximum Solids Size	Shipping Weight lbs/kg
SP024V	1/4	115	2.4	10	1	Built-In Vertical	10'	1 1/4"	6"	3"	9"	3/8"	8 / 3.6
SP024AT						Piggyback Wide Angle	10'	1 1/4"	11"	5"	12"		
SP025V						Built-In Vertical	10'	1 1/2"	6"	3"	9"		
SP025AT						Piggyback Wide Angle	10'	1 1/2"	11"	5"	12"		
SP035V	1/3	115	3.0	10	1	Built-In Vertical	10'	1 1/2"	6"	3"	9"	3/8"	8 / 3.6
SP035M						Plug / No Switch	10'	1 1/2"	6"	3"	9"		
SP035AT						Piggyback Wide Angle	10'	1 1/2"	11"	5"	12"		

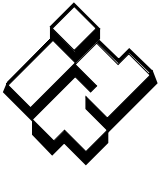

ITT

Wastewater



Goulds Pumps and the ITT Engineered Blocks Symbol are registered trademarks and tradenames of ITT Corporation.

SPECIFICATIONS ARE SUBJECT TO CHANGE WITHOUT NOTICE.

BSP02/03 August, 2006

© 2006 ITT Corporation

Engineered for life