



# grinder pumps

**Dual Mechanical Seals!**



**Rugged cast iron submersible pump provides capacities to 42 GPM and heads to 112 feet. Dual cutter design reduces sewage to a fine slurry. Dry motor features stainless steel shaft and ball bearings. Silicon carbide seals provide less friction, better resistance to wear, more thermal protection and**

**greater corrosion resistance. Options available are lift out system components, control panels, switches, alarms and basin assemblies.**

### APPLICATIONS

- Sewage grinding
- Sewage, effluent and wastewater removal or transfer

### ORDERING INFORMATION

Catalog Number	HP	Volts	Phase*	Full Load Amps	Discharge
SG11200220T	2	230	1	13.4	1-1/4" NPT
SG11200320M	2	230/460	3	8.2/4.1	1-1/4" NPT

\*3 phase models are pre-wired for 230 volt.

In order to provide the best products possible, specifications are subject to change.

## SG SERIES RESIDENTIAL

### SPECIFICATIONS

- Motor Housing** – Cast iron
- Pump Casing** – Cast iron
- Seal Housing** – Cast iron
- Shaft** – Stainless steel
- Impeller** – Cast iron
- Cutters** – Stainless steel 440C hardened to 55-60 Rockwell C dual cutter design
- Upper and Lower Bearings** – Single row ball bearing shielded
- Fasteners** – Stainless steel

### FEATURES

**Motor** – *Dry motor design:* Capacitor start/capacitor run which provides maximum starting torque required to start with trash. Motor windings contain automatic thermal overload protection. Single-phase unit has a time proven springloaded mechanical switch.

**Mechanical Seals** – Dual mechanical seals in cast iron housing filled with oil for lubrication. Seals are silicon carbide at the pump's water side and carbon ceramic at the motor side. Silicon carbide provides longer life at the critical seal area. Seal features Buna-N elastomers and stainless steel hardware.

**Duty** – Pumps are rated 105°F continuous, 122°F intermittent.

**Shaft** – Stainless steel eliminates corrosion and fatigue for longer pump life. Short shaft extension to reduce deflection and prolong seal and bearing life.

**Float Switch** – SJE Pumpmaster Plus 20'.

**Impeller** – Cast iron 10 vane for maximum clearing of particles.

**Adjustable Mounting Feet** – Stainless steel provided with rubber bottoms to reduce vibration.

**Cord** – 14ga. SOW (3 phase) and 16ga SOW (1 phase) with secondary strain relief 20'.

# grinder pumps

## OUTLINE DIMENSIONS

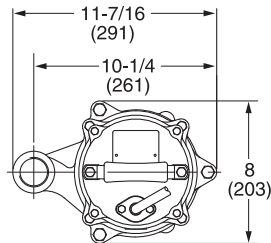

Phase	Dimension A
1	25 (635)
3	21-5/8 (549)

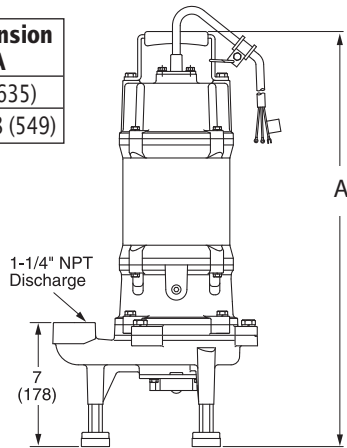

Dimensions in inches (mm) are for estimating purposes only.

## PUMP PERFORMANCE

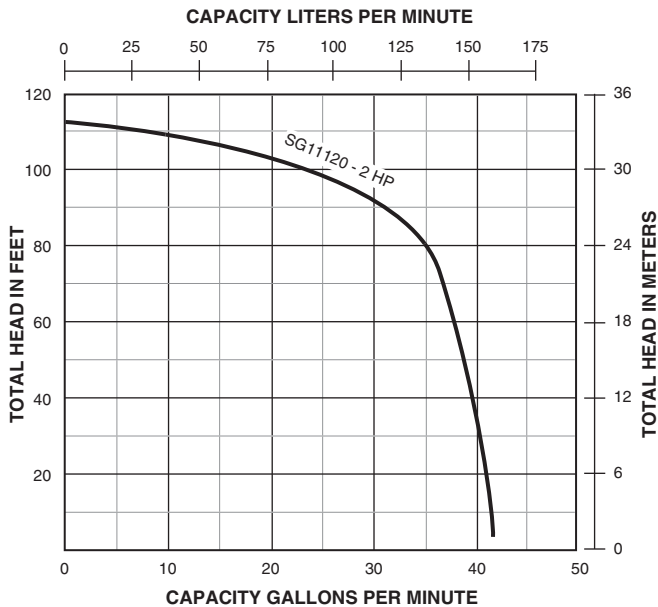

## CROSS-SECTIONAL VIEW

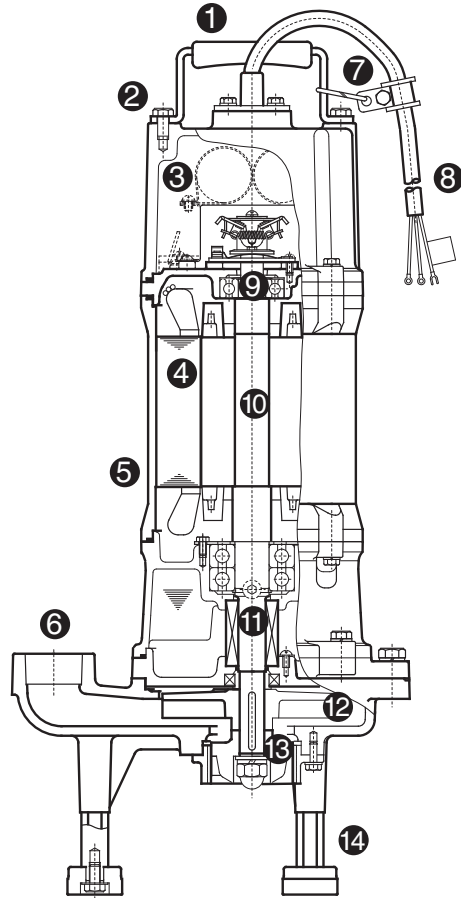

- 1 Rubber coated handle.
- 2 All hardware stainless steel.
- 3 Dry capacitor and switch housing for ease of servicing.
- 4 Dry capacitor start/run motor provides maximum starting torque. No need for control panel on single phase units.
- 5 Cast iron housings with baked on epoxy coating to resist corrosion.
- 6 1-1/4" Discharge.
- 7 Secondary cord strain relief.
- 8 14 gauge or 16 gauge SOW cord for maximum oil and water resistance. Easily serviceable.
- 9 Upper and lower heavy duty ball bearings.
- 10 Stainless steel shaft.
- 11 Dual mechanical seals in an oil chamber. Silicon carbide at the water end; carbon ceramic at the motor end.
- 12 Cast iron 10 vane impeller for maximum clearing of particles.
- 13 Hardened 440c stainless cutters and cutting ring. Replaceable without disassembling pump.
- 14 Stainless steel legs with rubber feet adjustable to 1/2".