



cast iron submersible effluent pumps



The EC9 Series Pump is a rugged, submersible cast iron pump with a non-clog, semi-open impeller and solids handling capability to 3/4". Unit is available in 230V/1ph and 208-230V/460V/3ph and comes complete with a 20' power cord. 2" NPT vertical discharge is standard. A full selection of accessories for automatic operation is available, and includes

float switches, duplex controllers, simplex controllers, alarms, basins and check valves.

APPLICATIONS

- Effluent and Wastewater Removal
- Sump Drainage
- Dewatering
- Flood Control

ORDERING INFORMATION

Catalog Number	HP	Max. Load Amps	Volts	Phase/Cycles	Cord Length	Mechanical Switch Type
EC9200220M	2	9.3	230	1/60	20'	Manual
EC9200320M	2	7.5	208-230	3/60	20'	Manual
EC9200420M	2	3.8	460	3/60	20'	Manual

NOTE: All EC9 Series Pumps have 3/4" solids handling capability and 2" NPT discharge.

In order to provide the best products possible, specifications are subject to change.

EC9 SERIES

SPECIFICATIONS

Impeller/Volute Casing – Cast iron
Upper and Lower Motor Housing – Cast iron

Shaft Seal – *Primary:* mechanical type 6A or equal, Buna-N elastomers, silicon carbide sealing faces, stainless steel metal parts
Secondary: self-lubricating lip seal

Bearings – Ball type, oil lubricated

Exterior Hardware and Nameplate – Stainless steel

Motor – 2 HP, 3450 RPM, 230V single phase or 208-230V/460V three phase, 60 Hz, oil-filled. Built-in thermal overload protection with automatic reset and permanent split capacitor on single phase only. Stainless steel motor shaft and impeller lock nut.

Power Cord – *Single Phase:* 20' oil and water resistant 16-3 SJTW-A/SJTW with integrally grounded 3-prong plug. UL listed.
Three Phase: 20' oil and water resistant 16-4 STW-A/STW.

Maximum Liquid Temperature Limits – 130°F (55°C)

FEATURES

Dual Shaft Seals – Primary mechanical seal with a secondary self-lubricating lip seal.

Impeller – Non-clog semi-open style.

Bearings and Mechanical Seal – Permanently lubricated for long life.

Overload Protection – Built-in thermal overload with automatic reset on single phase.

Stainless Steel Hardware – Allows for easy disassembly after extended service.

Solids Handling – 3/4" spherical capabilities.

Cord Design – Prevents oil loss from the motor.

Controls – Standard controls available for automatic operation.

cast iron submersible effluent pumps

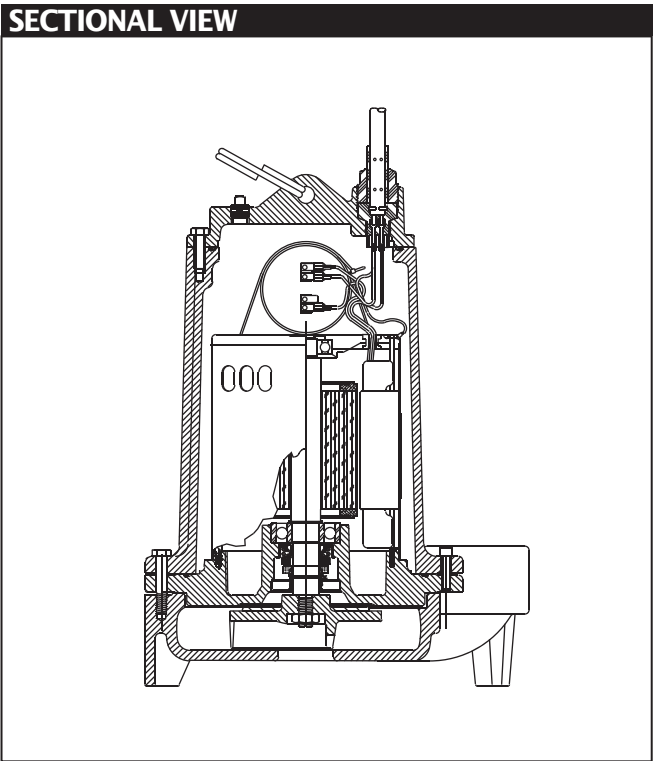
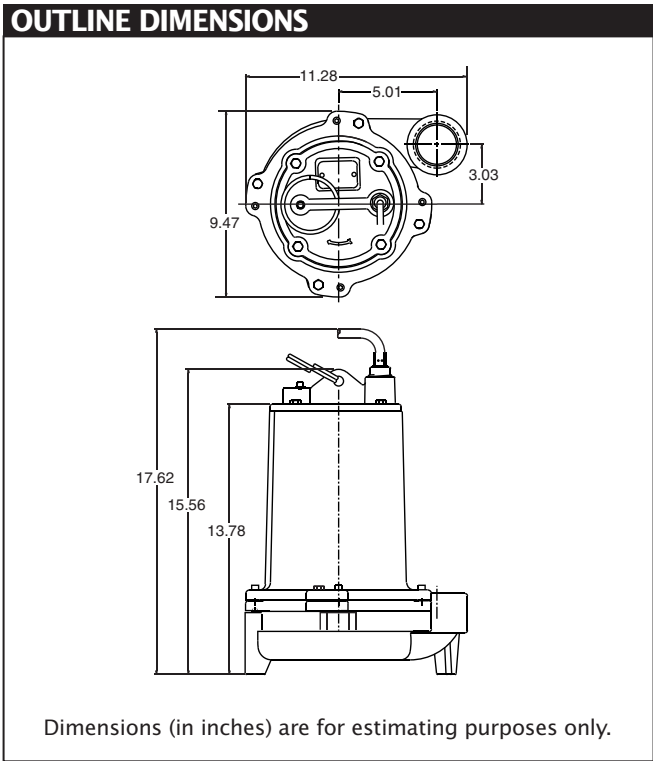

PUMP PERFORMANCE

