



cast iron submersible effluent pumps



The EC2 Series Submersible Pumps are constructed of rugged cast iron, with a non-clog vortex impeller typically used in septic tank effluent applications. Product is available in 4/10 HP, 115 Volt, single phase, complete with a 10' or 20' power cord and 1-1/2" NPT vertical discharge. Automatic units have field-replaceable piggy-back tethered style float switches. A full selec-

tion of accessories for automatic operation is available, and includes float switches, simplex and duplex controllers, basins, alarms and check valves.

APPLICATIONS

- Effluent and Wastewater Removal
- Sump Drainage
- Circulation
- Water Transfer

ORDERING INFORMATION

Catalog Number	HP	Maximum Load Amps	Volts	Phase/Cycles	Cord Length	Mechanical Switch Type	Switch Setting	
							On	Off
EC240110M	4/10	12.5	115	1/60	10'	Manual	—	—
EC240110T	4/10	12.5	115	1/60	10'	Tethered	14"	5"
EC240120M	4/10	12.5	115	1/60	20'	Manual	—	—
EC240120T	4/10	12.5	115	1/60	20'	Tethered	14"	5"

Noryl® is a registered trademark of General Electric Co. In order to provide the best products possible, specifications are subject to change.

EC2 SERIES

SPECIFICATIONS

- Upper Volute** – Cast iron
- Motor Cover** – Cast iron
- Lower Volute Base** – Fiberglass reinforced polypropylene
- Impeller** – Fiberglass reinforced Noryl® with threaded brass insert
- Shaft Seal** – Mechanical, carbon/ceramic
- Bearings** – Upper sleeve and lower ball bearings, oil lubricated
- O-Rings** – Buna-N
- Exterior Hardware** – Stainless steel
- Motor** – 4/10 HP, 1550 RPM, 115 Volt, 60 Hz. Class B insulation. Oil-filled shaded pole containing built-in thermal overload protection with automatic reset.
- Power Cord** – 10' or 20' water resistant 16-3 gauge, type SJTW-A/SJTW with integrally grounded 3-prong plug.
- Maximum Liquid Temperature Limits** – 130°F (55°C)

FEATURES

- Construction** – Heavy-duty cast iron motor housing and upper volute. Corrosion-resistant composite base ideal for effluent applications.
- Bearings and Mechanical Seal** – Permanently lubricated for long life.
- Cord Seal** – Prevents oil loss from and protection for motor if cord is damaged.
- Overload Protection** – Built-in thermal overload with automatic reset.
- Power Cord** – Field replaceable.
- Intake** – Built-in suction screen.
- Impeller** – Pump out vanes for seal protection.
- Solids Handling** – 1/2" spherical capability.



cast iron submersible effluent pumps

OUTLINE DIMENSIONS

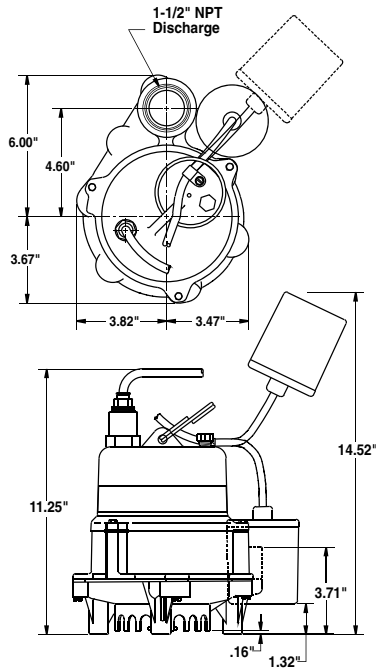

Dimensions (in inches) are for estimating purposes only.

SECTIONAL VIEW

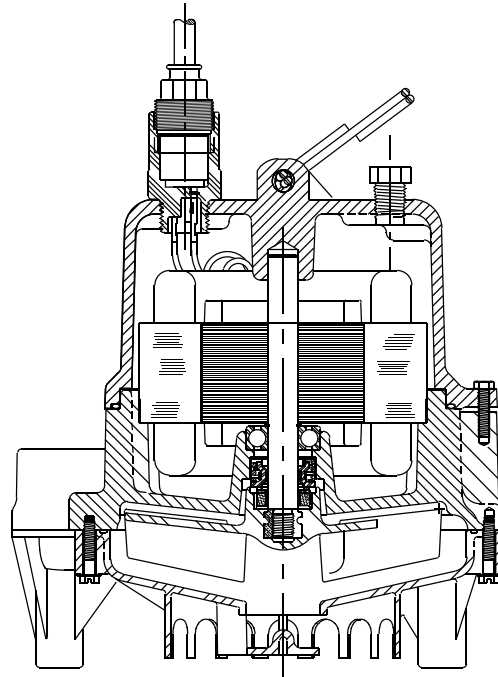

PUMP PERFORMANCE

