

ACS-2 & 3 Auxiliary Condensate Overflow Safety Switch



Applications

- Installs in condensate drain pan of air conditioning or refrigeration units; reliable equipment shutdown when overflow conditions are detected

Features

- Easy to install, inspect and maintain
- Compact design mounts to side of A/C condensate drain pans
- Detects high condensate levels in drain pans and shuts off the system
- Can be installed to activate audible or visual alarm circuitry
- ABS housing and float
- Complies with applicable building codes
- Switches can be wired to operate as NO or NC
- **Operation:**
 - ACS-2 — 48 VAC/DC max, 5 amps max
 - ACS-3 — 125-250 VAC max, 11 amps max, up to 1/3 HP
- **Lead wires:**
 - ACS-2 — 18" and 72" leads
 - ACS-3 — 72" leads

Dimensional Drawing

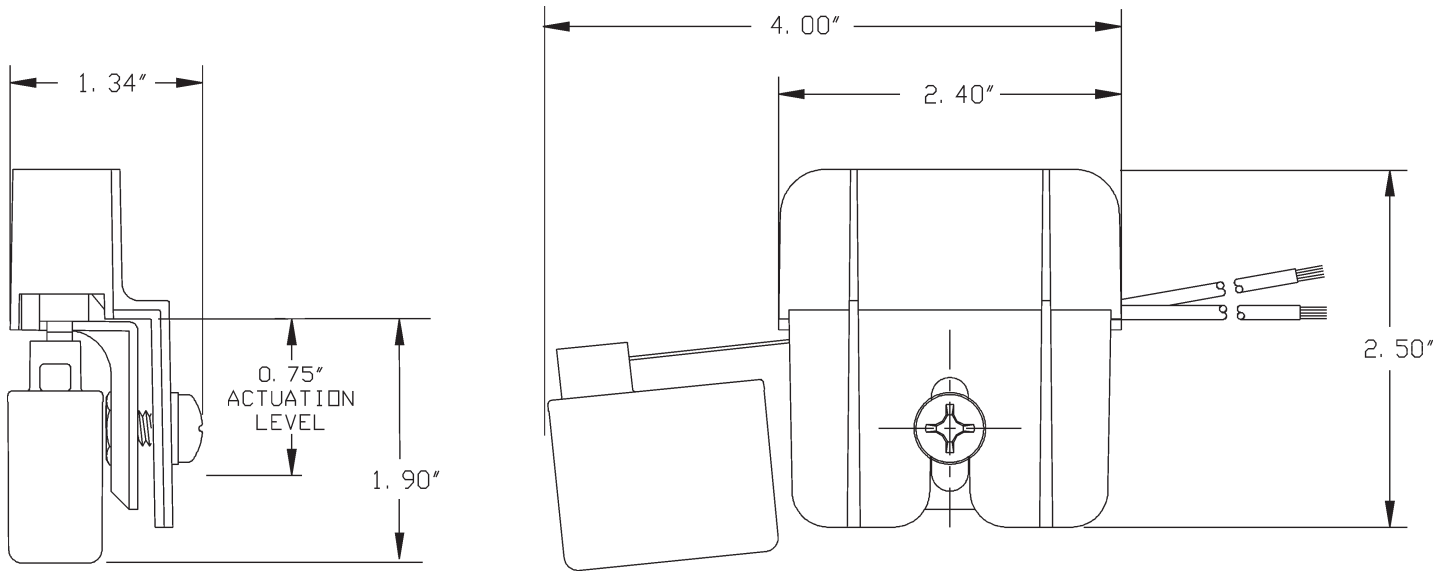

Specifications

Item No.	Model No.	Volts	Amps	HP	Lead Length	Master Qty.	Weight (lbs.)
599122	ACS-2	48 VAC/DC	5 max.	—	18"	24	.21
599123	ACS-2	48 VAC/DC	5 max.	—	72"	24	.29
599124	ACS-3	125-250VAC	11 max.	1/3 max.	72"	24	.29



Franklin Electric

P.O. Box 12010
 Oklahoma City, OK 73157-2010
 Phone: 1.800.701.7894
 Fax: 1.800.678.7867
 www.LittleGiantPump.com