

Little Giant[®]

SP-12



Features

- Ideal for heavy duty use in basements or light commercial applications needing frequent water drainage
- 10' Power Cord
- Handles up to 1/2" solids
- 1/2 HP thermally protected motor, oil-filled for lifetime lubrication
- 1-1/2" FNPT discharge
- Minimum basin size: 18" diameter x 24" deep
- ON Level: 14" - 16"
OFF Level: 6" - 8"

Construction

- Motor — 1/2 HP shaded pole
- Flow Rate — 73 GPM @ 5'
- Maximum Head — 21.2'
- Intermittent Liquid Temp. up to 120° F
- Discharge — 1-1/2" FNPT
- Housing — Cast iron
- Volute — ABS
- Impeller — Nylon, glass-filled
- Shaft Seal — Carbon/Ceramic
- Electrical — 115V, 60Hz, 11.5A, thermal overload protection

This pump is designed to provide efficient, trouble-free service in moving large volumes of water. Applications include excavation site, crawl space, basements, underground passageways, loading docks, construction sites among others.

SP-12

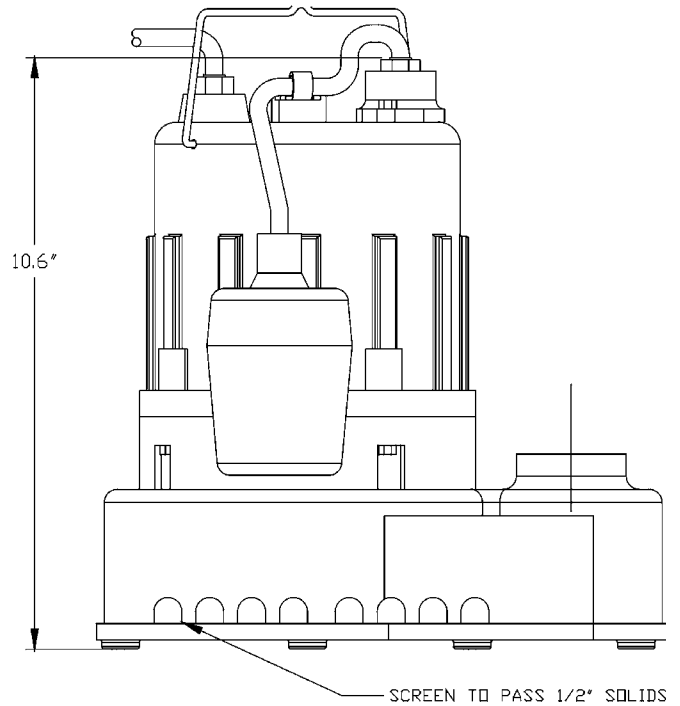
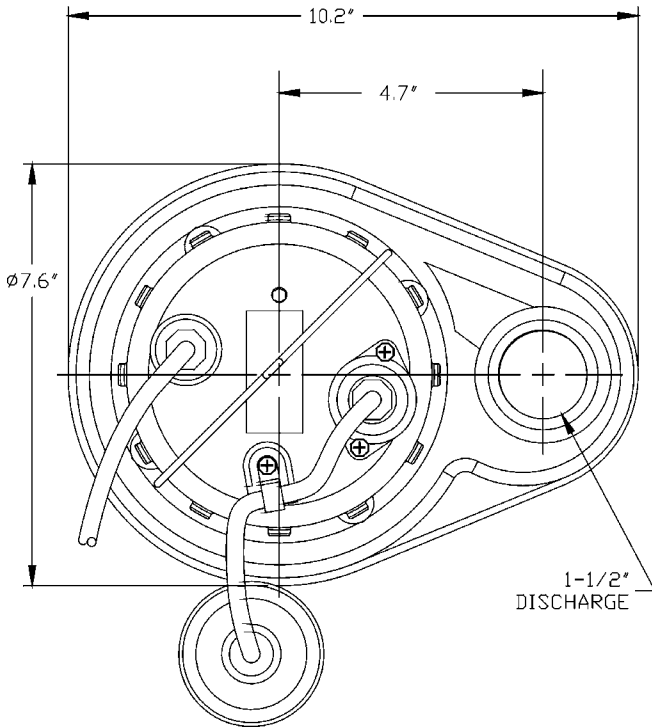

Specifications

Model No.	Item No.	Discharge	Listings	HP	Volts	Hertz	Amps	Watts	Performance (GPM @ Head)				Shut Off Feet	PSI	Pwr. Cord (ft.)	Weight (lbs.)	Height	Length	Width
									5'	10'	15'	20'							
SP-12	577103	1-1/2" FNPT	UL/CSA	1/2	115	60	11.5	910	73	60	38	7	21.2	9.2	10	28.00	11.0	10.2	7.6

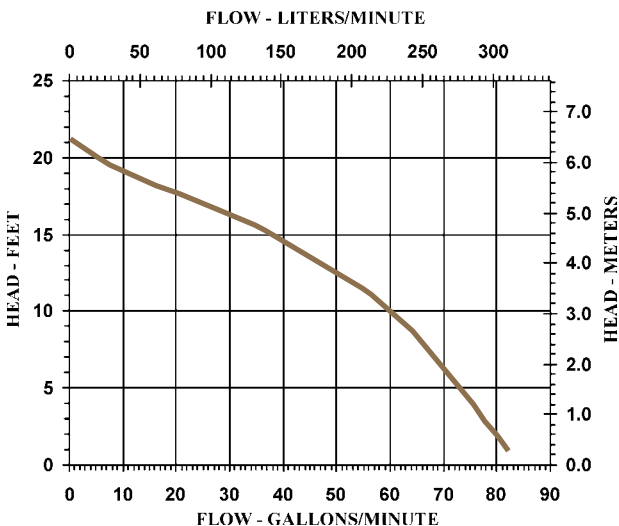

SP-12 Series

Head (ft.)	Flow (GPM)	Head (m)	Flow (LPM)
1	82	0.3	310
5	73	1.5	276
10	60	3.0	227
15	38	4.6	144
19	11	5.8	42
21.2	0	6.5	0

Little Giant

PO Box 12010 • Oklahoma City, OK 73157
 Phone: 888.956.0000 • Fax: 800.701.8046
 E-mail: customerservice@littlegiant.com