

"QUALITY PUMPS SINCE 1939"

Product information presented here reflects conditions at time of publication. Consult factory regarding discrepancies or inconsistencies.

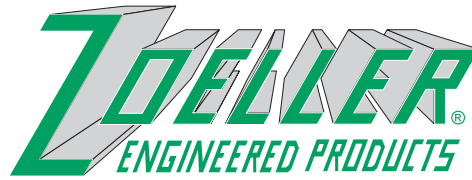

SECTION: Z3.40.100
 ZM2439
 Rev. A
 1110
 Supersedes
 0209

MAIL TO: P.O. BOX 16347 • Louisville, KY 40256-0347
 SHIP TO: 3649 Cane Run Road • Louisville, KY 40211-1961
 (502) 778-2731 • 1 (800) 928-PUMP • FAX (502) 774-3624

visit our web site:
www.zoeller.com



X62 HD HAZARDOUS ENVIRONMENT SERIES

CLASS 1, DIVISION 1, GROUP C & D

PRODUCT FEATURES

4" & 6" Flanged Discharge Units



Covered by US Patent Number 6,364,620.

APPLICATIONS

- Engineered Lift Stations.
- Storm Water Removal.
- Wastewater Transfer.
- Industrial Wastewater.
- Class 1, Division 1 Hazardous Locations.
- **WARNING:** Not for use in acidic atmospheres.

SPECIFICATIONS

PUMP:

- Solids - 3" spherical capability.
- Discharge size - 4" & 6" horizontal flanged.
- Seals - dual mechanical carbon/rotary, ceramic/stationary, Buna-N elastomers.
- Balanced concentric pump housing and impeller.
- Construction - Cast Iron ASTM A-48, Class 30, 30,000# tensile strength, corrosion resistant powder coated epoxy finish.
- Attaching hardware - 304 stainless steel.
- O-ring elastomers - Buna-N.
- Impeller - 2 blade semi-open Ductile Iron with top pump out vanes.
- Moisture detection system.
- Optional:

<input type="checkbox"/> Silicon Carbide Seal(s).	<input type="checkbox"/> 50' Power and Sensor Cables.
<input type="checkbox"/> Viton O-ring Elastomers.	<input type="checkbox"/> Trimmed Impeller.
<input type="checkbox"/> Vortex Impeller.	<input type="checkbox"/> Non-sparking Rail Systems.
<input type="checkbox"/> Bronze Impeller.	

MOTOR:

- FM Listed Class 1, Division 1, Group C & D construction.
- 1 Phase - 230 Volt, 1750 RPM (5 and 7.5 BHP).
- 3 Phase - 200/230/460/575 Volt, 1750 RPM.
- 5 thru 20 BHP.
- Stator - Class F insulation and lead wires. Nema B design.
- Thermal sensor and leads.
- Housing - Class 30 cast iron, finned, oil-filled.
- Ball Bearings - Dual high carbon chromium steel.
- Power cable length - 25'.

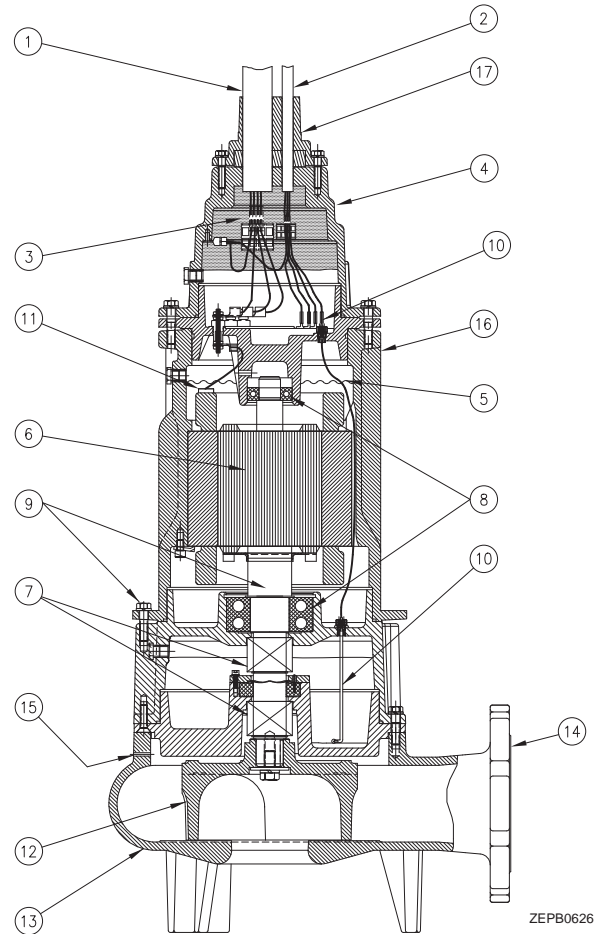

ZEPB0626

FEATURES

- 25' of extra heavy duty power cable. 50' optional.
- 25' sensor cable. 50' optional.
- Specially designed splices and potted cord entry system provides strain relief and prevents wicking of liquids into the housing.
- Lifting lugs integral part of housing (not shown).
- Oil-filled motor housing with finned casting assures uniform heat distribution, lubricates bearings, and conducts heat for cooler running.
- Heavy duty motor features ball bearing construction. Class F motor insulation is double dipped and baked. End connections and lead wires are Class F. At maximum load, winding temperature will not exceed 250°F with motor housing not submerged.
- Tandem seals. Carbon/rotating, ceramic/stationary, Buna-N elastomers. Optional seal materials available.
- Upper and lower high carbon chromium steel ball bearings.
- Stainless steel shaft and hardware resists corrosion.
- Patented moisture detection system with upper and lower probes, protecting the motor from liquid entry.
- Thermal sensor will deactivate pump if internal motor temperature reaches 250°F.
- Balanced 2 vane semi-open impeller with top pump out vanes for seal protection keyed and bolted to shaft. Recessed vortex design also available as an option.
- Concentric case reduces radial loading for longer bearing and seal life.
- 4" or 6" flanged horizontal discharge.
- Vent hole helps prevent air locking.
- Entire unit protected with a corrosion resistant powder coated epoxy finish.
- 2½" threaded conduit connection.

For additional information on the X62 HD Series pumps, refer to catalog on Performance information, ZM2440 and ZM2530; Dimensional Data information, ZM2531 and ZM2532; Guide Specifications, ZM2535; Replacement Parts List and Repair Manual, ZM2455 and Owner's Manual, ZM2454.

For information on additional Zoeller products refer to catalog on Rail Systems, ZM1347; Control Panels, ZM1342; Float Switches, ZM1536; Float Switch Brackets, ZM1328; Pump Lifting Cables, ZM1328; Check Valves and Piping Accessories, ZM1348.

X62 HD HAZARDOUS ENVIRONMENT SERIES

CLASS 1, DIVISION 1, GROUP C & D

TECHNICAL DATA

5 - 20 BHP

4" & 6" Flanged Discharge Units



MODEL NUMBER:	<input type="checkbox"/> X6220	<input type="checkbox"/> X6221	<input type="checkbox"/> X6222	<input type="checkbox"/> X6223	<input type="checkbox"/> X6224
PUMP NAME PLATE HORSEPOWER: BHP	5.0	7.5	10.0	15.0	20.0
NEC LOCKED ROTOR CODE:	D	F	C	E	B
MAXIMUM KW INPUT:	5.2	7.8	9.8	13.5	16.8
IMPELLER DIAMETERS: in (mm) STANDARD	6 7/8" (175mm)	7 3/8" (187mm)	7 3/4" (197mm)	8 5/8" (219mm)	9 1/2" (241mm)
DISCHARGE SIZE:	<input type="checkbox"/> 4" FLANGED HORIZONTAL or <input type="checkbox"/> 6" FLANGED HORIZONTAL				
<input type="checkbox"/> Standard Hydraulic Design - REF ZM2440 <input type="checkbox"/> Vortex Hydraulic Design - REF ZM2530 <input type="checkbox"/> High Headed Hydraulic Design (4" discharge only) - REF ZM2440					

SOLID SIZE: in (mm)	3" (75 mm)	TANDEM SEALS:	STANDARD		
IMPELLER TYPE:	DUCTILE IRON SEMI-OPEN	MOTOR DESIGN LETTER:	NEMA B		
	OPTION: <input type="checkbox"/> DUCTILE IRON VORTEX <input type="checkbox"/> BRONZE SEMI OPEN	CORD LENGTH: ft (m)	25' (7.6) <input type="checkbox"/> 50' (15.2)		
FLANGE:	ANSI B16.1	SENSOR CORD SIZE:	#18 - 5		
PUMP NET WEIGHT: lbs. (kg)	350 lbs. (159kg)	POWER CORD SIZE:	#12-4	#8-4	#4-4
			AMPS:	< 20	< 36.7
MOTOR SHAFT:	416 SS	STATOR & LEAD WIRES INSULATION:	CLASS F		
RPM:	1750	MAXIMUM STATOR TEMPERATURE:	311°F (155°C)		
MOTOR TYPE:	EXPLOSION PROOF SUBMERSIBLE				

SHAFT SEAL CONSTRUCTION:	STANDARD	CARBON/CERAMIC
	OPTIONAL UPPER	<input type="checkbox"/> CARBON / SILICON CARBIDE <input type="checkbox"/> SILICON CARBIDE/SILICON CARBIDE
	OPTIONAL LOWER	<input type="checkbox"/> CARBON / SILICON CARBIDE <input type="checkbox"/> SILICON CARBIDE/SILICON CARBIDE
O-RING ELASTOMERS	STANDARD	BUNA-N
	OPTIONAL	<input type="checkbox"/> VITON
STANDARD SENSING DEVICES*	MOTOR THERMAL SHUTOFF	THERMAL SENSORS WITH AUTOMATIC RESET
	MOISTURE DETECTION	MOISTURE SENSING PROBES
IMPELLER TRIM:	<input type="checkbox"/> OPTIONAL	DESIGN POINT: _____ GPM @ _____' TDH, IMPELLER DIA. _____"
RECOMMENDED FLUID LEVEL FOR CONTINUOUS OPERATIONS: in (m)	24" (0.6m)	(For Continuous Duty, Refer to Warranty)
MAXIMUM WATER TEMPERATURE:	104°F (40°C)	

*Requires a circuit in control panel to function.

MODEL	BHP	SERVICE FACTOR	<input type="checkbox"/> 230V / 1 PHASE		<input type="checkbox"/> 200V / 3 PHASE		<input type="checkbox"/> 230V / 3 PHASE		<input type="checkbox"/> 460V / 3 PHASE		<input type="checkbox"/> 575V / 3 PHASE	
			FLA	LRA	FLA	LRA	FLA	LRA	FLA	LRA	FLA	LRA
X6220	5.0	1.2	27.5	91	17.5	61.9	15.2	53.8	7.6	26.9	6.1	21.8
X6221	7.5	1.2	36.7	137	25.0	109	22.0	95	11.0	47.5	9.0	37.8
X6222	10.0	1.2	N/A	N/A	32.0	109	28.0	95	14.0	47.5	11.0	37.8
X6223	15.0	1.2	N/A	N/A	48.3	197	41.7	172	20.9	86.0	16.4	70.0
X6224	20.0	1.0	N/A	N/A	59.4	197	54.0	172	27.0	86.0	22.0	70.0