

"QUALITY PUMPS SINCE 1939"

Product information presented here reflects conditions at time of publication. Consult factory regarding discrepancies or inconsistencies.

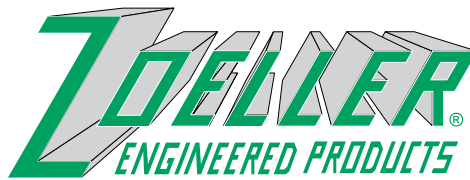

SECTION: Z2.20.100
ZM2310
0409
Supersedes
0706

MAIL TO: P.O. BOX 16347 • Louisville, KY 40256-0347
SHIP TO: 3649 Cane Run Road • Louisville, KY 40211-1961
(502) 778-2731 • 1 (800) 928-PUMP • FAX (502) 774-3624

visit our web site:
www.zoeller.com



62 HD SERIES PRODUCT FEATURES 4" & 6" Flanged Discharge Units Models: 6220 6221 6222 6223 6224



Covered by US Patent Number 6,364,620.

APPLICATIONS

- Engineered Lift Stations.
- Storm Water Removal.
- Wastewater Transfer.
- Industrial Wastewater.

SPECIFICATIONS

PUMP:

- Solids - 3" spherical capability.
- Discharge Size - 4" & 6" horizontal flanged.
- Seals - dual mechanical carbon/rotary, ceramic/stationary, Buna-N elastomers.
- Construction - Cast Iron ASTM A-48, Class 30, 30,000# tensile strength, corrosion resistant powder coated epoxy finish.
- Attaching Hardware - 304 stainless steel.
- O-ring Elastomers - Buna-N.
- Impeller - 2 blade semi-open Ductile Iron with top pump out vanes.
- Moisture detection system.
- Optional:

| | |
|--|--|
| <input type="checkbox"/> Silicon Carbide Seal(s). | <input type="checkbox"/> Dry Pit Configuration (5-15 BHP). (Not CSA Listed). |
| <input type="checkbox"/> Viton O-ring Elastomers. | <input type="checkbox"/> High Temperature Construction. (Not CSA Listed). |
| <input type="checkbox"/> Vortex Impeller. | <input type="checkbox"/> Inverter Duty Motors. (Not CSA Listed). |
| <input type="checkbox"/> Bronze Impeller. | <input type="checkbox"/> Rail Systems. |
| <input type="checkbox"/> Trimmed Impeller. | |
| <input type="checkbox"/> Additional Cord Length _____. | |



MOTOR:

- 1 Phase - 230 Volt, 1750 RPM (5 and 7.5 BHP).
- 3 Phase - 200/230/460/575 Volt, 1750 RPM.
- 5 thru 20 BHP.
- Stator - Class F insulation and lead wires. Nema B design.
- Thermal sensor and leads.
- Housing - Class 30 cast iron, finned, oil-filled.
- Ball Bearings - Dual high carbon chromium steel.
- Power Cable Length - 25'.

FEATURES

1. 25' of extra heavy duty power cable.
2. Protected cable entrance. The compression grommet allows for field replacement of the cable. Optional: 3" heavy wall conduit threads for protection of cable assemblies.
3. Potted cords. Each conductor individually sealed to eliminate cord wicking of liquids.
4. Lifting lugs integral part of housing (not shown).
5. Oil-filled motor housing with finned casting assures uniform heat distribution, lubricates bearings, and conducts heat for cooler running.
6. Heavy duty motor features ball bearing construction. Class F motor insulation is double dipped and baked. End connections and lead wires are Class F. At maximum load, winding temperature will not exceed 250°F with motor housing not submerged.
7. Tandem seals. Carbon/rotating, ceramic/stationary, Buna-N elastomers. Optional seal materials available.
8. Upper and lower high carbon chromium steel ball bearings.
9. Stainless steel shaft and hardware resists corrosion.
10. Patented moisture detection system with upper and lower probes, protecting the motor from liquid entry.

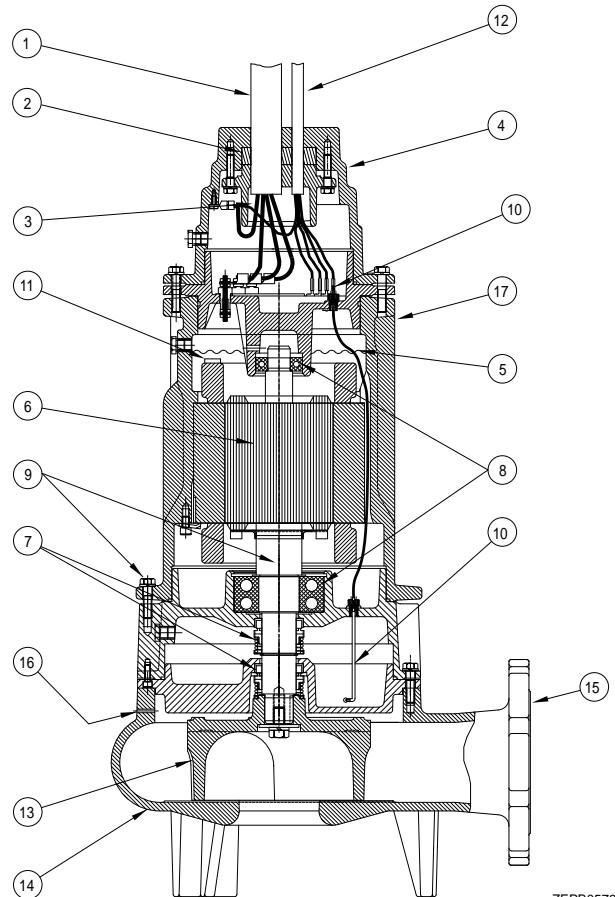

ZEPB0578

11. Thermal sensor provides protection against overheating.
12. 25' sensor cable.
13. Balanced 2 vane semi-open impeller with top pump out vanes for seal protection keyed and bolted to shaft. Recessed vortex design also available as an option.
14. Concentric case reduces radial loading for longer bearing and seal life.
15. 4" or 6" flanged horizontal discharge. Dry pit units available upon request.
16. Vent hole helps prevent air locking.
17. Entire unit protected with a corrosion resistant powder coated epoxy finish.

For additional information on the 62 HD Series pumps, refer to catalog on Performance information, ZM2348 and ZM2349; Dimensional Data information, ZM2311, ZM2312, ZM2313 and ZM2314; Guide Specifications, ZM2350; Replacement Parts List and Repair Manual, ZM2354 and Owner's Manual, ZM2353.

For information on additional Zoeller products refer to catalog on Rail Systems, ZM1347; Control Panels, ZM1342; Float Switches and J-Boxes, ZM1536; Float Switch Brackets, ZM1328; Pump Lifting Cables, ZM1328; Check Valves and Piping Accessories, ZM1348.



62 HD SERIES TECHNICAL DATA

4" & 6" Flanged Discharge Units 5 - 20 BHP



| | | | | | |
|--------------------------------------|--|-------------------------------|-------------------------------|-------------------------------|-------------------------------|
| MODEL NUMBER: | <input type="checkbox"/> 6220 | <input type="checkbox"/> 6221 | <input type="checkbox"/> 6222 | <input type="checkbox"/> 6223 | <input type="checkbox"/> 6224 |
| PUMP NAME PLATE HORSEPOWER: BHP | 5.0 | 7.5 | 10.0 | 15.0 | 20.0 |
| NEC LOCKED ROTOR CODE: | D | F | C | E | B |
| MAXIMUM KW INPUT: | 5.2 | 7.8 | 9.8 | 13.5 | 16.8 |
| IMPELLER DIAMETERS: in (mm) STANDARD | 6 7/8" (175mm) | 7 3/8" (187mm) | 7 3/4" (197mm) | 8 5/8" (219mm) | 9 1/2" (241mm) |
| DISCHARGE SIZE: | <input type="checkbox"/> 4" FLANGED HORIZONTAL or <input type="checkbox"/> 6" FLANGED HORIZONTAL | | | | |
| | <input type="checkbox"/> Standard Hydraulic Design - REF ZM2349 <input type="checkbox"/> Vortex Hydraulic Design - REF ZM2348 <input type="checkbox"/> High Headed Hydraulic Design (4" discharge only) - REF ZM2349 | | | | |

| | | | | | |
|----------------------------|--|---------------------------------|---|------|--------|
| SOLID SIZE: in (mm) | 3" (75 mm) | TANDEM SEALS: | STANDARD | | |
| IMPELLER TYPE: | DUCTILE IRON SEMI-OPEN | MOTOR DESIGN LETTER: | NEMA B | | |
| | OPTION: <input type="checkbox"/> DUCTILE IRON VORTEX <input type="checkbox"/> BRONZE SEMI OPEN | CORD LENGTH: ft (m) | 25' (7.6 m) <input type="checkbox"/> _____' | | |
| FLANGE: | ANSI B16.1 | SENSOR CORD SIZE: | #18 - 5 | | |
| PUMP NET WEIGHT: lbs. (kg) | 350 lbs. (159kg) | POWER CORD SIZE: | #12-4 | #8-4 | #4-4 |
| MOTOR SHAFT: | 416 SS | | AMPS: | < 20 | < 36.7 |
| RPM: | 1750 | STATOR & LEAD WIRES INSULATION: | CLASS F | | |
| MOTOR TYPE: | STANDARD SUBMERSIBLE | MAXIMUM STATOR TEMPERATURE: | 311°F (155°C) | | |
| | <input type="checkbox"/> *INVERTER DUTY SUBMERSIBLE | *DRY PIT (5 - 15 BHP) | <input type="checkbox"/> | | |
| | | *HIGH TEMPERATURE | <input type="checkbox"/> (175°F MAX.) | | |

| | | |
|---|-----------------------------------|--|
| SHAFT SEAL CONSTRUCTION: | STANDARD | CARBON/CERAMIC |
| | OPTIONAL UPPER | <input type="checkbox"/> CARBON / SILICON CARBIDE <input type="checkbox"/> SILICON CARBIDE/SILICON CARBIDE |
| | OPTIONAL LOWER | <input type="checkbox"/> CARBON / SILICON CARBIDE <input type="checkbox"/> SILICON CARBIDE/SILICON CARBIDE |
| O-RING ELASTOMERS | STANDARD | BUNA-N |
| | OPTIONAL | <input type="checkbox"/> VITON |
| STANDARD SENSING DEVICES** | MOTOR THERMAL SHUTOFF | THERMAL SENSORS WITH AUTOMATIC RESET |
| | MOISTURE DETECTION | MOISTURE SENSING PROBES |
| IMPELLER TRIM: | <input type="checkbox"/> OPTIONAL | DESIGN POINT: _____ GPM @ _____' TDH, IMPELLER DIA. _____" |
| RECOMMENDED FLUID LEVEL FOR CONTINUOUS OPERATIONS: in (m) | | 24" (0.6m) (For Continuous Duty, Refer to Warranty) |
| MAXIMUM WATER TEMPERATURE: | | 104°F (40°C) |

*Contact factory. These configurations are not CSA Listed.

**Requires a circuit in control panel to function.

| MODEL | BHP | SERVICE FACTOR | <input type="checkbox"/> 230V / 1 PHASE | | <input type="checkbox"/> 200V / 3 PHASE | | <input type="checkbox"/> 230V / 3 PHASE | | <input type="checkbox"/> 460V / 3 PHASE | | <input type="checkbox"/> 575V / 3 PHASE | |
|-------|------|----------------|---|-----|---|------|---|------|---|------|---|------|
| | | | FLA | LRA | FLA | LRA | FLA | LRA | FLA | LRA | FLA | LRA |
| 6220 | 5.0 | 1.2 | 27.5 | 91 | 17.5 | 61.9 | 15.2 | 53.8 | 7.6 | 26.9 | 6.1 | 21.8 |
| 6221 | 7.5 | 1.2 | 36.7 | 137 | 25.0 | 109 | 22.0 | 95 | 11.0 | 47.5 | 9.0 | 37.8 |
| 6222 | 10.0 | 1.2 | N/A | N/A | 32.0 | 109 | 28.0 | 95 | 14.0 | 47.5 | 11.0 | 37.8 |
| 6223 | 15.0 | 1.2 | N/A | N/A | 48.3 | 197 | 41.7 | 172 | 20.9 | 86.0 | 16.4 | 70.0 |
| 6224 | 20.0 | 1.0 | N/A | N/A | 59.4 | 197 | 54.0 | 172 | 27.0 | 86.0 | 22.0 | 70.0 |