



Submittal Data Information

101-148

Hot-Link® Domestic Hot Water Recirculation System

Effective: October 29, 2010

Supersedes: New

Job: _____ Engineer: _____ Contractor: _____ Rep: _____

ITEM NO.	MODEL NO.	

HLS-1 Includes:

- Hot-Link® Valve
- Hot-Link® Circulator
- (2) Braided Flex Hoses
- 3/4" Bronze Union

Materials of Construction — Pump & Union

- Casting (Volute).....Stainless Steel
- Stator Housing.....Steel
- Cartridge.....Stainless Steel
- Impeller.....Noryl
- Shaft.....Ceramic
- Bearings.....Carbon
- O-Ring.....EPDM
- Union.....Bronze

Materials of Construction — Hot-Link® Valve

- Body.....Nylon
- Thermal Disk Actuator.....Bi-Metal
- O-Ring Seals.....EPDM
- Integral Flow Check (IFC®):
 - Body, Plunger.....Acetal
 - O-Rings.....EPDM
- Screen.....304 SS
- Stem.....Nylon
- Actuator Cartridge.....Low Lead Brass
- Braided Flex Hoses.....Stainless Steel

Pump Performance Data

- Pump Flow Range.....0-11 gpm
- Head Range.....0-10 ft.
- Min. Fluid Temperature.....40°F (4°C)
- Max. Fluid Temperature.....220°F (104°C)
- Max. Working Pressure.....125 psi



FOR INDOOR USE ONLY

- NSF® ≤ .25% Lead
- Complies with California Health and Safety Code Section 116875 / AB1953 and Vermont Act 193

Application:

The Taco Hot-Link® System for domestic hot water recirculation reduces the time it takes for hot water comfort to reach showers and faucets by recirculating “cooled” water back to the water heater; hot water lines remain hot. The Hot-Link system can save an average family up to 12,000 gallons of water per year – water that normally goes down the drain while waiting for hot water.

Dimensions & Weights

Hot-Link® Valve

Connection	A		B		C		D		Ship Wt.	
	in.	mm	in.	mm	in.	mm	in.	mm	Lbs.	Kg
1/2" MNPT	4	102	3-1/8	79	1-5/8	41	2	51	0.30	0.14

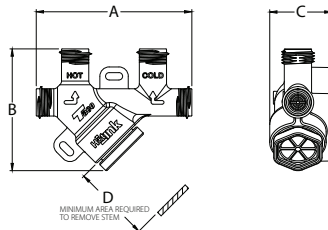

Hot-Link® Circulator

A		B		C		D		E		F		Ship Wt.	
in.	mm	in.	mm	in.	mm	in.	mm	in.	mm	in.	mm	Lbs.	Kg
7-1/4	184	1-15/16	49	2	51	3-1/16	78	5-1/4	134	3-5/16	84	7.0	3.2

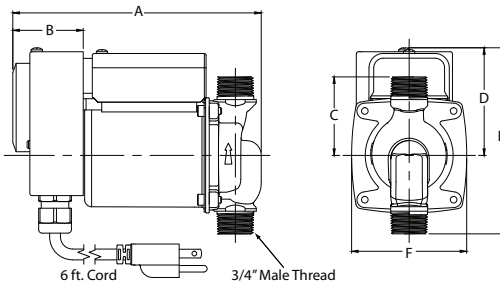

Electrical Data

Model	Volts	Hz	Ph	Amps	RPM	HP
Hot-Link® Circulator	115	60	1	.55	3250	1/40
Motor Type	Permanent Split Capacitor Impedance Protected					

Do it Once. Do it Right.®

TACO INC., 1160 Cranston Street, Cranston, RI 02920 Telephone: (401) 942-8000 Fax: 942-2360
 TACO (Canada), Ltd., 6180 Ordan Drive, Mississauga, Ontario L5T 2B3 Telephone: (905) 564-9422 Fax: (905) 564-9436
 Visit our website at: www.taco-hvac.com

Printed in USA
 Copyright 2010
 TACO, Inc.