

# ITT

BJDW

## Residential Water Systems

# Goulds Pumps

## J05X, J05K, J05L

Convertible Pump / Tank Packages



 **GOULDS PUMPS**

Goulds Pumps is a brand of ITT Corporation.

[www.goulds.com](http://www.goulds.com)

*Engineered for life*

### **PUMP FEATURES**

---

■ **Serviceable:**

- Back pullout design allows disassembly of pump for service without disturbing piping.
- Two compartment motor for easy access to motor wiring and replaceable components.
- Corrosion resistant, engineered plastic tubing and fittings.

■ **Powered for Continuous Operation:** Pump ratings are within the motor manufacturer's recommended working limits. Can be operated continuously without damage.

■ **Excellent Air Handling Ability:** After initial priming the pump has the ability to re-prime itself even when air gets into the system. Pumping resumes once the water level rises above the foot valve.

### **TANK FEATURES**

---

■ **Maximum Working Pressure:** 100 PSI

■ **Temperature Rating:** Maximum 120° F

■ **Exterior Finish:** High durability exterior finish of tough, powder coat over a zinc phosphate surface treatment.

■ Tanks are designed for installation indoors or where they are protected from rain, irrigation overspray, salt air and other corrosive environments. Always protect tanks from freezing.

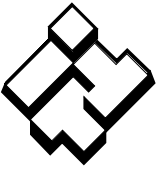

# ITT

## GOULDS PUMPS Residential Water Systems

### APPLICATIONS

---

Home, farm and cottage water systems and booster service.

### PUMP SPECIFICATIONS

---

#### Pump:

- Pipe connections:
  - 1" NPT pressure
  - 1¼" NPT suction
  - 1" NPT discharge.
- Pressure switch:
  - AS4 preset 30-50 PSI

#### Motor:

- NEMA service factor.
- 60 Hz.
- ½ HP, 115/230 V capacitor start.
- 3500 RPM.
- Built-in overload with automatic reset.
- Stainless steel shaft.

### TANK FEATURES

---

- **Deep Drawn Steel Shells:** Provide maximum material strength.
- **Inner Shell:** Prevents diaphragm from over-expanding.
- **Heavy Duty Diaphragm:** Made of finest quality butyl rubber. Separates air and water, maintains air charge.
- **Interior Tank Lining:** Fusion bonded polymeric lining (durable polypropylene liner used on V15P). Both meet FDA requirements.
- **Maximum Working Pressure:** 100 PSI for V45MP and V60MP, 125 PSI for V15P.
- **Temperature Rating:** Maximum 120° F.
- **Appliance Appearance Exterior Finish:** Two coat high performance protection system.
- **Heavy Duty Base:** Eliminates corrosion due to condensation and exposure to the elements. Made of high density polypropylene.

### ADDITIONAL COMPONENTS REQUIRED

---

- **Shallow Well Package:** Includes shallow well adapter, nozzle, venturi (diffuser), gasket, bolts and pipe plugs  
or
- **Deep Well Package:** Choose either a twin pipe or packer style.
  - Twin pipe includes jet body, nozzle, venturi (diffuser) and foot valve.
  - Packer includes packer body, nozzle, venturi (diffuser), and built-in check valve.**NOTE:** Packer systems also require a packer adapter on the wellhead.

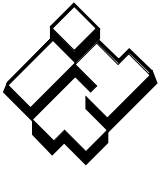

# ITT

## GOULDS PUMPS Residential Water Systems

### ORDER INFORMATION

| Model No. | HP | Replacement Pump Model No. | Tank Model | Drawdown at |           |
|-----------|----|----------------------------|------------|-------------|-----------|
|           |    |                            |            | 20/40 PSI   | 30/50 PSI |
| J05X      | ½  | J5                         | V15P       | 1.7         | 1.4       |
| J05K      | ½  | J05LT                      | V45MP      | 5.1         | 4.3       |
| J05L      | ½  | J05LT                      | V60MP      | 7.3         | 6.1       |

### SHALLOW WELL PERFORMANCE RATINGS

| HP/Model                  | ½ HP – J05LT       |                          |      |     |                     | ½ HP – J05LT               |                          |      |     |     |                     |
|---------------------------|--------------------|--------------------------|------|-----|---------------------|----------------------------|--------------------------|------|-----|-----|---------------------|
| Shallow Well Package      | FH5                |                          |      |     |                     | FH5H (High Pressure Model) |                          |      |     |     |                     |
| Adapter                   | 4K62               |                          |      |     |                     |                            |                          |      |     |     |                     |
| Nozzle                    | AN017              |                          |      |     |                     | AN019                      |                          |      |     |     |                     |
| Venturi                   | AD3731             |                          |      |     |                     | AD3528                     |                          |      |     |     |                     |
|                           |                    | Discharge Pressure – PSI |      |     |                     |                            | Discharge Pressure – PSI |      |     |     |                     |
| Total Suction Lift (feet) | 20                 | 30                       | 40   | 50  | Max. Shut off (PSI) | 20                         | 30                       | 40   | 50  | 60  | Max. Shut off (PSI) |
|                           | Gallons per minute |                          |      |     |                     | Gallons per minute         |                          |      |     |     |                     |
| 5                         | 17.5               | 16.5                     | 10.2 | 5.0 | 63                  | 11.5                       | 11.3                     | 11.0 | 7.7 | 4.8 | 83                  |
| 10                        | 15.7               | 14.4                     | 9.2  | 4.3 | 61                  | 10.3                       | 10.0                     | 9.6  | 7.0 | 4.2 | 81                  |
| 15                        | 13.7               | 12.5                     | 8.0  | 3.6 | 59                  | 8.8                        | 8.6                      | 8.3  | 6.3 | 3.7 | 79                  |
| 20                        | 11.5               | 10.4                     | 7.1  | 2.3 | 57                  | 7.0                        | 7.0                      | 6.8  | 5.8 | 3.2 | 76                  |
| 25                        | 8.7                | 8.6                      | 6.2  | 1.3 | 54                  | 5.3                        | 5.2                      | 5.2  | 5.0 | 2.8 | 73                  |

### TWIN PIPE PERFORMANCE RATINGS

| HP/Model   | ½ HP – J05LT    |           |        |        |
|--|-----------------|-----------|--------|--------|
| Well Casing min. I.D.                                  | 4               |           | 4½     |        |
| Pressure   | 1               |           | 1¼     |        |
| Suction  | Pipe Size (in.) |           | 1¼     |        |
| ① Jet Assembly Package                                 | FT4-13          | FT4-31    | FT4-08 | FT5-14 |
| Jet Body (only)  | AT4             |           | AT5    |        |
| Nozzle   | AN017           | AN016     | AN015  | AN018  |
| Venturi  | AD726           | AD723     | AD720  | AD724  |
| Control Valve Setting (PSI)                            | 30              | 30        | 30     | 30     |
|  |                 | 30-50 PSI |        |        |
| Depth to Jet Assembly (based on submergence of 5 feet) | Feet            |           |        |        |
|  | 30              | 13.0      | 11.0   |        |
|  | 40              | 11.8      | 9.0    |        |
|  | 50              |           | 7.6    | 6.9    |
|  | 60              |           | 7.0    | 5.2    |
|  | 70              |           |        | 4.7    |
|  | 80              |           |        | 3.8    |
|  | 90              |           |        | 3.1    |
| 100  |                 |           |        |        |

① Jet assembly package includes:  
jet body, nozzle, Venturi and foot valve.

### SYSTEM DIMENSIONS

| Model | Tank | Tank Wt. (lb.) | Total Wt. (lb.) |
|-------|------|----------------|-----------------|
| J05X  | V15P | 11.9           | 63              |

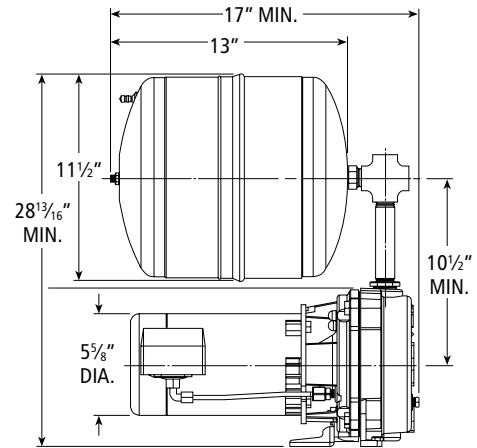

| Model | A (in.) | B (in.) | Tank  | Tank Wt. (lb.) | Total Wt. (lb.) |
|-------|---------|---------|-------|----------------|-----------------|
| J05K  | 34.2    | 25.5    | V45MP | 27.8           | 71.0            |
| J05L  | 41.7    | 33.0    | V60MP | 40.0           | 83.0            |

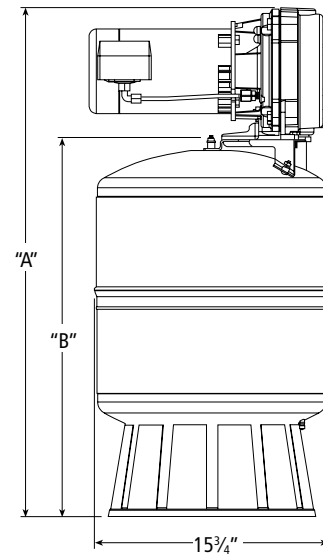

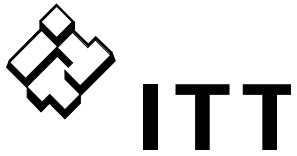

**ITT**

**2881 East Bayard Street, Seneca Falls, NY 13148**

**Phone: (315) 568-7123 • Fax: (315) 568-7973**

**[www.goulds.com](http://www.goulds.com)**

Goulds Pumps is a registered trademark of ITT Corporation. ITT, the Engineered Blocks Symbol and Engineered for Life are registered trademarks of ITT Manufacturing Enterprises, Inc.

Copyright © 2009 ITT Corporation      BJDW      October, 2009      Printed in U.S.A.  
SPECIFICATIONS ARE SUBJECT TO CHANGE WITHOUT NOTICE.