

**TOTAL DYNAMIC HEAD/FLOW  
SEWAGE AND DEWATERING**

| MODEL          |        | 264           |        |
|----------------|--------|---------------|--------|
| Feet           | Meters | Gallons       | Liters |
| 5              | 1.5    | 90            | 341    |
| 10             | 3.0    | 60            | 227    |
| 15             | 4.6    | 23            | 87     |
| Shut-off Head: |        | 18 ft (5.5 m) |        |

009931

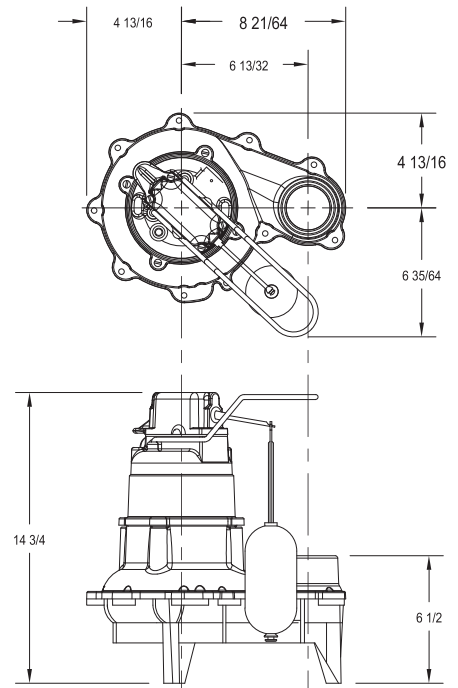

SK1643

**CONSULT FACTORY FOR SPECIAL APPLICATIONS**

- Electrical alternators for duplex systems available with variable level float switches.
  - Minimum recommended basin size  
Simplex-18"x30"  
Duplex-30"x36"
  - Standard Automatic - Weight 34.5 lbs. .4 H.P.
  - High water alarms available.
  - Mechanical alternators available for duplex systems.
- ▲ CAUTION** Maximum temperature of sewage or dewatering must be limited to 130°F (54°C). For over 130°F (54°C) special quotation required.
- For "M" and "D" models, the approximate gallons pumped out per cycle are:
- | Tank Diameter | Gallons Pumped |
|---------------|----------------|
| 18" Simplex   | 8 Gallons      |
| 24" Simplex   | 15 Gallons     |
| 30" Duplex    | 22 Gallons     |
| 36" Duplex    | 33 Gallons     |
| 48" Duplex    | 60 Gallons     |

| 264 MODELS |       |    |      | CONTROL SELECTION |         |        |
|------------|-------|----|------|-------------------|---------|--------|
| Model      | Volts | Ph | Mode | Amps              | Simplex | Duplex |
| M264       | 115   | 1  | Auto | 9.4               | 1       | 4      |
| N264       | 115   | 1  | Non  | 9.4               | 2 or 3  | 4      |
| D264       | 230   | 1  | Auto | 4.7               | 1       | 4      |
| E264       | 230   | 1  | Non  | 4.7               | 2 or 3  | 4      |

**SELECTION GUIDE**

1. Integral float operated mechanical switch, no external control required.
2. For automatic use single piggyback variable level float switch or double piggyback variable level float switch. Refer to FM0477.
3. See FM1228 for correct model of simplex control panel.
4. See FM0712 for correct model of duplex control panel or FM1663 for a residential alternator system.

**▲ CAUTION**

For information on additional Zoeller products refer to catalog on Piggyback Variable Level Float Switches, FM0477; Electrical Alternator, FM0486; Mechanical Alternator, FM0495; Sump/Sewage Basins, FM0487, and Single Phase Simplex Pump Control, FM1596; Alarm System, FM0732.

All installation of controls, protection devices and wiring should be done by a qualified licensed electrician. All electrical and safety codes should be followed including the most recent National Electric Code (NEC) and the Occupational Safety and Health Act (OSHA).

**RESERVE POWERED DESIGN**

For unusual conditions a reserve safety factor is engineered into the design of every Zoeller pump.



www.zoeller.com



MAIL TO: P.O. BOX 16347  
Louisville, KY 40256-0347  
SHIP TO: 3649 Cane Run Road  
Louisville, KY 40211-1961  
(502) 778-2731 • 1 (800) 928-PUMP  
FAX (502) 774-3624

Manufacturers of..

"QUALITY PUMPS SINCE 1939"